

Parts

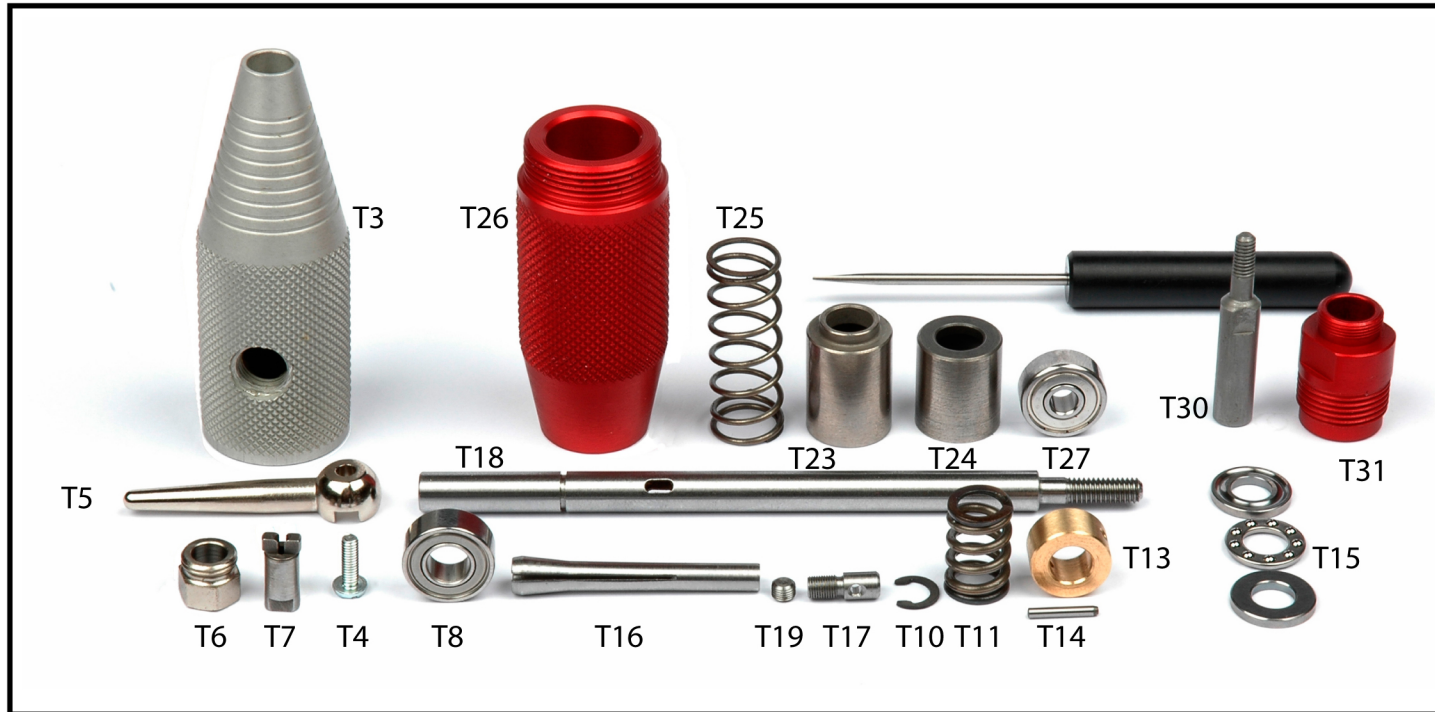

T3	Front Casing	T13	Draw Sleeve	T24	Spring Sleeve
T4	Lever Screw/washer	T14	Draw Sleeve Pin	T25	Large Spring
T5	Lever	T15	Shaft Thrust Bearing	T26	Rear Casing
T6	Hollow Screw	T16	Collet (2.35,3.00,3.18 mm)	T27	Rear Bearing
T7	Eccentric Pin	T17	Shaft Set Bolt		
T8	Front Bearing	T18	Shaft		
T10	Shaft Ring	T19	Colet Screw		
T11	Pressure Spring	T23	Operating Sleeve		

Connections

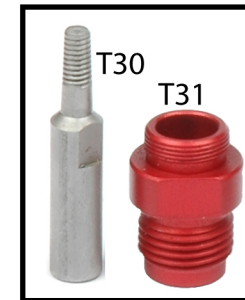

Duplex Spring Adaptator

- T30 Duplex Drive
- T31 Duplex Connection



US QD Connection

- T29 QD Connection
- T28 US Drive

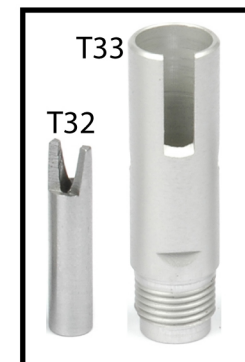

European Connection

- T33 European Connection
- T32 European Drive